

Rushmore Building
First Floor

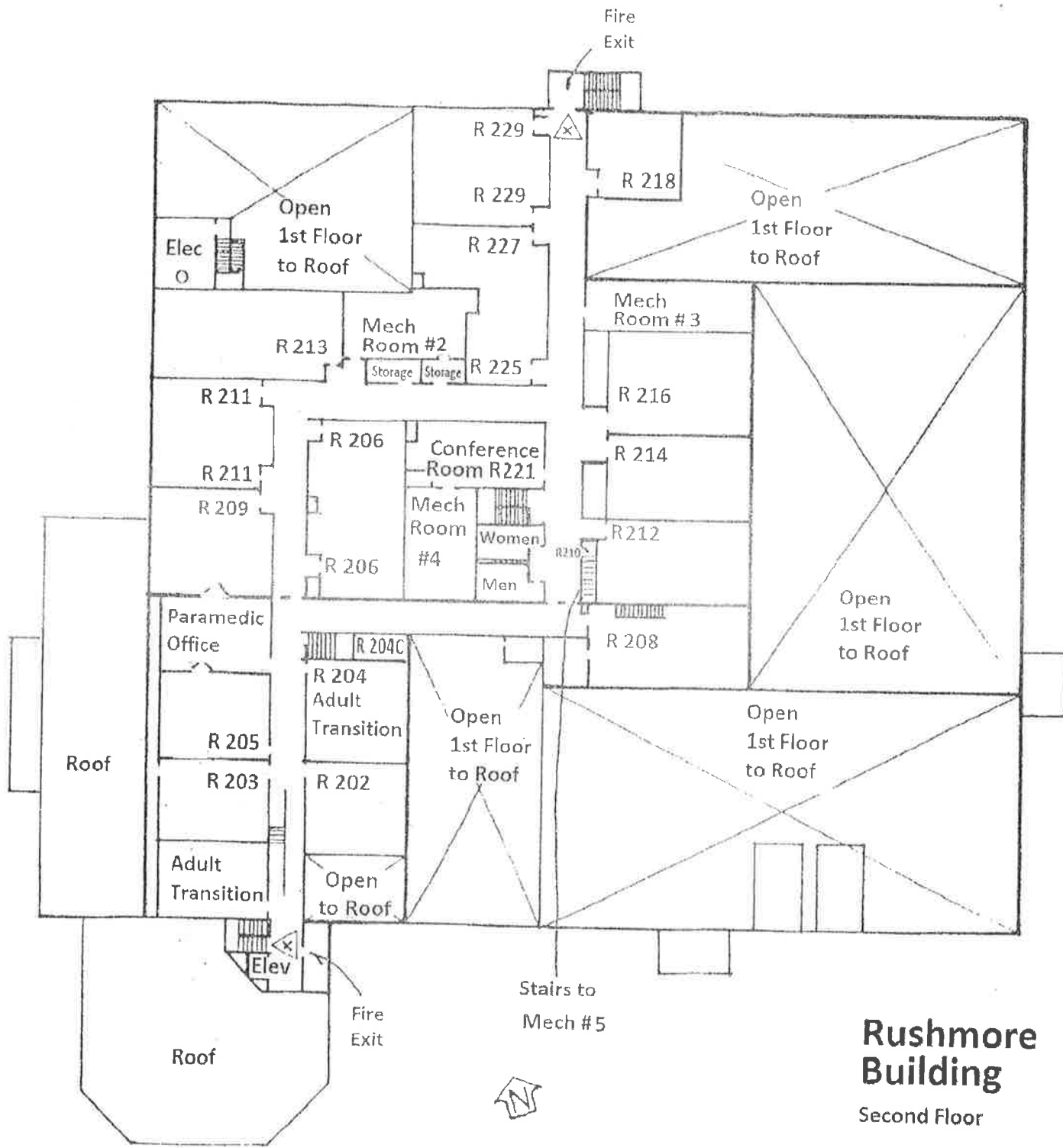

Rushmore Building
 Second Floor

122 fire science garage w/storeroom	5994	
		sub total
		62259
Department of Corrections		
West entry	48	
Foyer	168	
Office	166	
Hallways	827	
Rooms		
10	145	
11	144	
12	133	
13	226	
14	215	
15	137	
16	101	
17	198	
18	207	
19	127	
20	206	
21 conference room	946	
105 conference room w/office A	869	
Office B	137	
Office C	97	
		sub total
		5097
		First floor sub total
		67356
Rushmore Building - Second Floor		
Hallways		
West	1789	
South	906	
East	1432	
North	723	
Mens restroom	175	
Womens restroom	169	
Janitor closet	85	
Mechanical room #2	600	
Mechanical room #3	1014	
Storeroom	84	
Rooms		
200	276	
201 w/office and storeroom	856	
202	760	
203	748	
204	791	
204C	124	
205	1244	
206	1500	
207	377	

WDTI RUSHMORE CAMPUS**Rushmore Building Square footage - First floor**

Commons	3000
Commons office #1	133
Commons office #2	130
Commons DOC kitchen	463
Commons main kitchen w/janitor closet and storeroom	714
Hallways	
Commons restroom hallway and DOC exit hallway	450
West w/entry to west	1892
East w/entryway to north and w/diesel hallway	2115
North connector	500
South connector	500
Stairwells - south, central and north combined	446
Main entry	117
Elevator	29
Elevator mechanical room	52
Boiler room	518
Restrooms	
Main hallway womens	186
Main hallway mens	186
Commons mens	308
Commons womens	210
Rooms	
102	740
104	789
Distribution Center	151
106	125
107	966
108	1494
109	2046
110 Pennington Co. vehicle garage	3296
111	408
111A	1220
112 w/breakroom	752
113	855
113A	826
114 Pennington Co. shop	9724
114 classroom	765
115 (includes hallway, main garage and shop behind 113)	5786
117N w/office	955
117S	970
118	1494
118A	128
Parts room	824
Diesel shop	8827
120 w/office	1175

13,785

208 w/offices	1753	
209	1243	
210 (third floor mechanical room)	1766	
211	1205	
212	1067	
213	1690	
214 w/office	1096	
216 w/office	1096	
218	692	
221 w/mechanical room #4	851	
225/227	1573	
229	1283	
		Second floor sub total
		28968
		Rushmore Building square footage total
		96324
1500 Sedivy Lane "Daycare"		
Office	598	
Entry	166	
Restroom and mechanical room	114	
Main room	1016	
Hallway	78	
North room w/restrooms	997	
West room w/restroom	632	
South room w/restrooms	896	
Kitchen	151	
Janitor closet	104	
		Total
		4752